



# EMAT Training Hub Handbook & Pricing

Pyramus House  
Grange Park  
NN4 5EA



# About the EMAT Training Hub

The EMAT Training Hub offers a selection of versatile meeting and training spaces with capacities of up to 100 delegates, making it perfect for meetings, workshops and larger events.

The Training Hub is based at Pyramus House, in Grange Park, Northampton, close to junction 15 of the M1 and a short drive from Northampton train station.

If you want to elevate your next meeting or training session contact us today to enquire about availability, pricing and to schedule a tour of our exceptional spaces.



**01604 215149**



**training@emat.uk**



**emat.uk**

**Discount  
available  
for educational  
partners**



# Discover our spaces

**Flexible room options:** choose between a variety of room sizes and combinations to accommodate both small group meetings and larger training sessions.

**Cutting-edge technology:** Rooms are equipped with modern audio-visual equipment, including projectors, screens, and sound systems, ensuring seamless presentations.

**Comfort and convenience:** Offers comfortable seating arrangements, natural lighting and climate control for a conducive learning and meeting environment.

**Central location:** East Midlands Academy Trust offices are conveniently located, with easy access to the M1 motorway and train station (9 minutes by taxi), making it hassle-free for attendees.

**Catering services:** Enhance your event with our catering options, providing refreshments and buffets tailored to your preferences and dietary requirements.

**Professional atmosphere:** Enjoy a professional and inviting environment that encourages engagement and productivity.

**Experienced support:** Our dedicated team will assist you in planning and setting up, ensuring your event runs smoothly from start to finish.

**Affordable rates:** We offer competitive pricing packages for a range of budgets.

**Inspiring surroundings:** We offer an educational setting that fosters creativity and growth, offering a calm and purposeful environment for your event.

# Room Hire: Herne Room

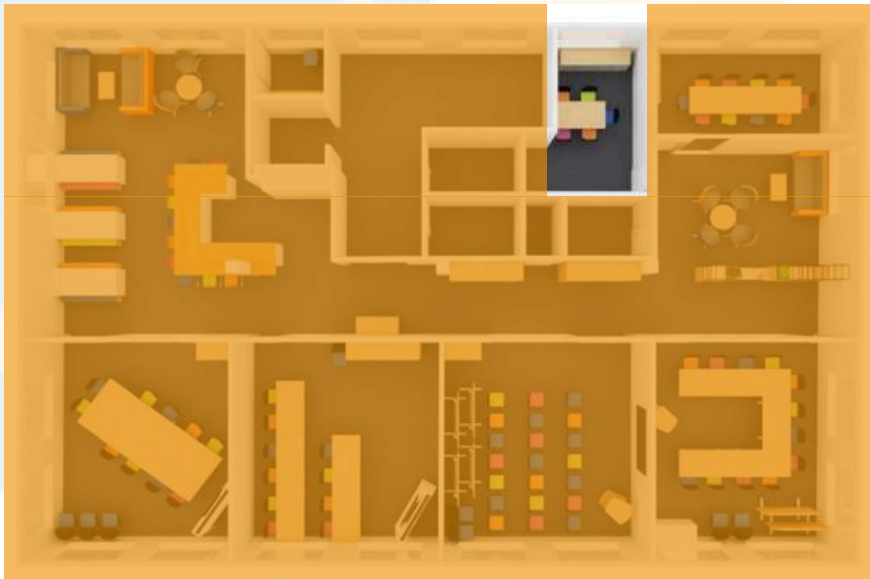

**Capacity:** up to 8 delegates

## HIRE CHARGE

Monday - Friday PER HOUR  
Monday - Friday DAY RATE

£12.00  
£85.00

*\*Bookings after 5pm may incur an additional charge*

Discount available for educational partners

## PARKING

Free parking available on site

## CATERING

Unlimited teas and coffees to be charged £3.00pp half day and £5.00pp full day

Catering to be pre-ordered through the reception 48 hours prior to booking.

**For more information please email [training@emat.uk](mailto:training@emat.uk)**

# Room Hire: Springfield Room



**Capacity:** up to 10 delegates

## HIRE CHARGE

Monday - Friday PER HOUR	£17.00
Monday - Friday DAY RATE	£110.00

*\*Bookings after 5pm may incur an additional charge*

Discount available for educational partners

## PARKING

Free parking available on site

## CATERING

Unlimited teas and coffees to be charged £3.00pp half day and £5.00pp full day

Catering to be pre-ordered through the reception 48 hours prior to booking.



For more information please email [training@emat.uk](mailto:training@emat.uk)

# Room Hire: Barrack Room

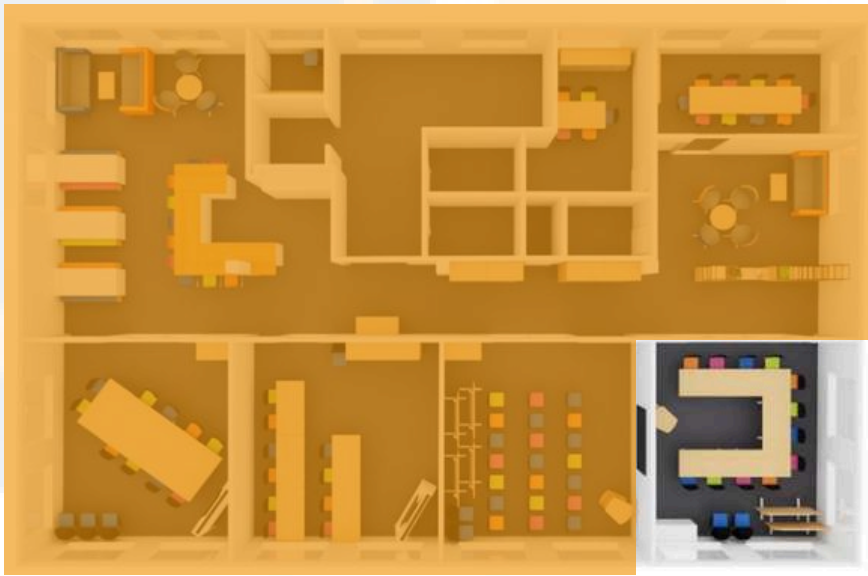

**Capacity:** up to 16 delegates

## HIRE CHARGE

Monday - Friday PER HOUR

£22.00

Monday - Friday DAY RATE

£135.00

*\*Bookings after 5pm may incur an additional charge*

Discount available for educational partners

## PARKING

Free parking available on site

## CATERING

Unlimited teas and coffees to be charged £3.00pp half day and £5.00pp full day

Catering to be pre-ordered through the reception 48 hours prior to booking.

**For more information please email [training@emat.uk](mailto:training@emat.uk)**

# Room Hire: George Room

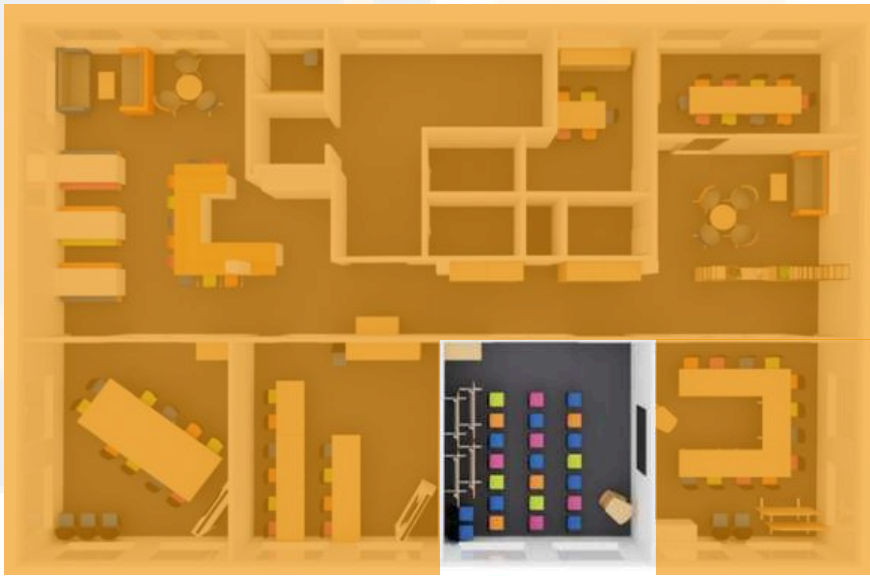

**Capacity:** up to 30 delegates

## HIRE CHARGE

Monday - Friday PER HOUR

£22.00

Monday - Friday DAY RATE

£135.00

*\*Bookings after 5pm may incur an additional charge*

Discount available for educational partners

## PARKING

Free parking available on site

## CATERING

Unlimited teas and coffees to be charged £3.00pp half day and £5.00pp full day

Catering to be pre-ordered through the reception 48 hours prior to booking.

**For more information please email [training@emat.uk](mailto:training@emat.uk)**

# Room Hire: Martins Room

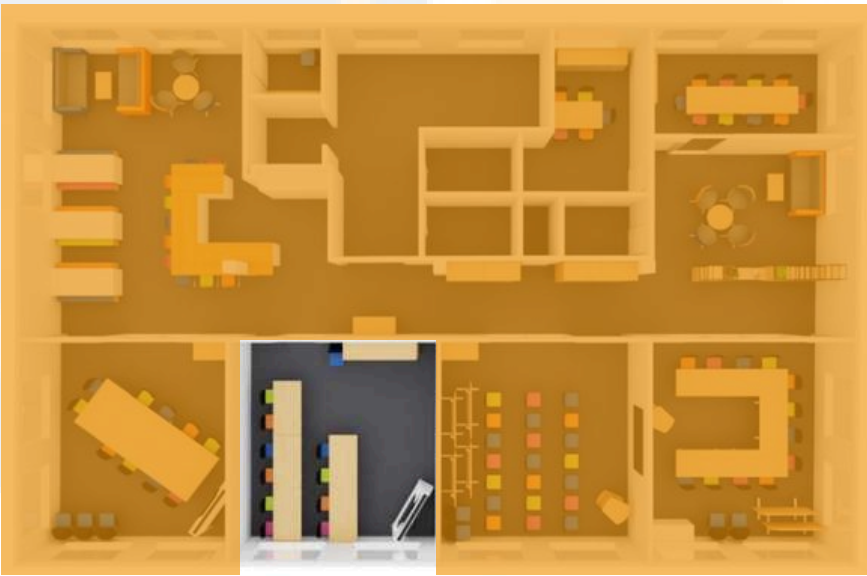

**Capacity:** up to 30 delegates

## HIRE CHARGE

Monday - Friday PER HOUR

£22.00

Monday - Friday DAY RATE

£135.00

*\*Bookings after 5pm may incur an additional charge*

Discount available for educational partners

## PARKING

Free parking available on site

## CATERING

Unlimited teas and coffees to be charged £3.00pp half day and £5.00pp full day

Catering to be pre-ordered through the reception 48 hours prior to booking.

**For more information please email [training@emat.uk](mailto:training@emat.uk)**

# Room Hire: Stimpson Room

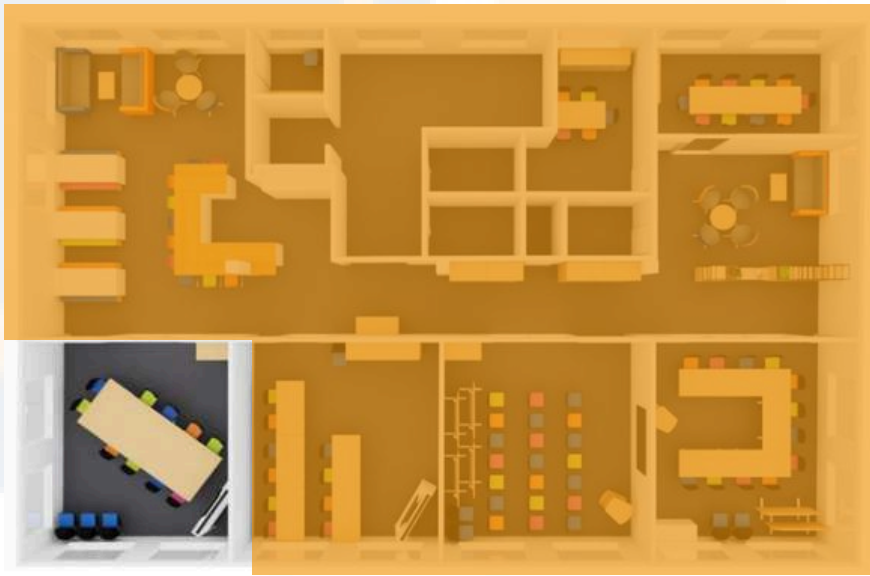

**Capacity:** up to 30 delegates

## HIRE CHARGE

Monday - Friday PER HOUR

£22.00

Monday - Friday DAY RATE

£135.00

*\*Bookings after 5pm may incur an additional charge*

Discount available for educational partners

## PARKING

Free parking available on site

## CATERING

Unlimited teas and coffees to be charged £3.00pp half day and £5.00pp full day

Catering to be pre-ordered through the reception 48 hours prior to booking.

**For more information please email [training@emat.uk](mailto:training@emat.uk)**

# Room Hire: Combination offers

Our flexible spaces can be combined to accommodate **up to 100 delegates**

Discount available for educational partners

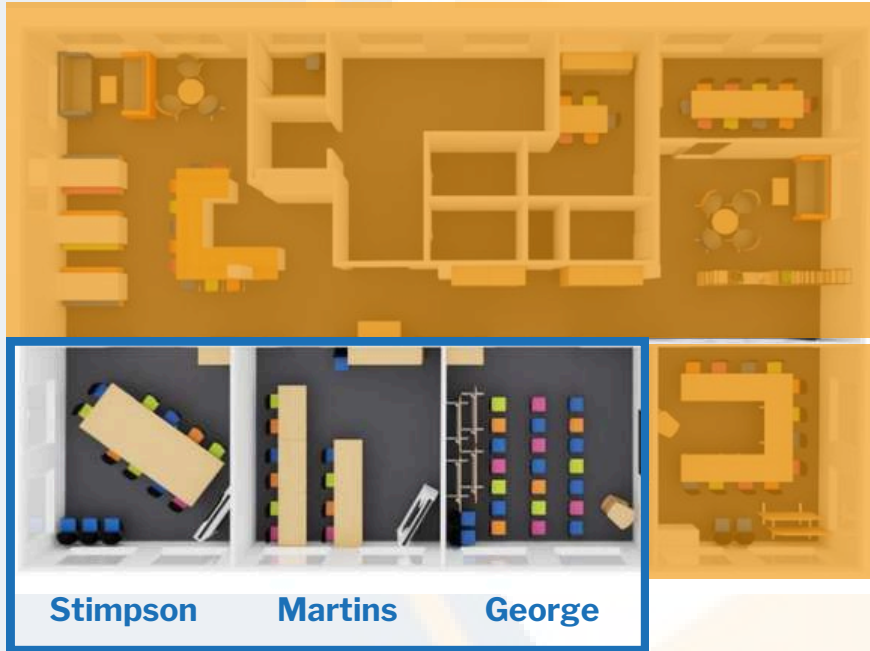

## GEORGE/MARTIN

Monday - Friday PER HOUR	£22.00
Monday - Friday DAY RATE	£160.00

## GEORGE/MARTIN/STIMPSON

Monday - Friday PER HOUR	£27.00
Monday - Friday DAY RATE	£225.00



*Bookings after 5pm may incur an additional charge*

**For more information please email [training@emat.uk](mailto:training@emat.uk)**



## Kitchenette and breakout areas

As well as our variety of meeting rooms, delegates also have access to the kitchenette and various breakout areas, providing plenty of options for discussions, networking or just taking a break.



# Room set-up options

Our rooms have the flexibility to comfortably accommodate the following capacities:

Room	Horseshoe/Presenting	Boardroom/Hollow Square	Theatre
Herne		Round table: 6 Long table: 8	
Springfield		Maximum: 10	
Barrack	Maximum: 12	Maximum: 16	
George	Maximum: 9	Maximum: 12	30
Martins	Maximum: 9	Maximum: 12	30
Stimpson	Maximum: 9	Maximum: 12	30
George/Martin			65 (8 across)
George/Martin/Stimpson			100 (8 across)

# Our feedback

The rooms were clean and well presented with effective IT facilities and all the equipment we needed. Good refreshments were provided and we were welcomed into the building and taken to the appropriate room by friendly reception staff

**Psychology4Learning**

Their well-equipped, spacious, and impeccably maintained training rooms create a comfortable and effective learning environment. The addition of a convenient refreshment area complete with a variety of snacks and beverages, enhances the overall experience, providing a space for relaxation and reflection during breaks.

What truly sets EMAT HUB apart is their incredibly helpful and friendly staff, always willing to assist with technical setup and any last-minute requests. We will be using their facilities in the future

**About Safeguarding**

I found the venue to be very accessible. The room was comfortable; warm with plenty of natural light. The horseshoe seating layout worked well and enabled the audience to view the screen and communicate with each other. Flipchart paper and pens were provided for activities. I would definitely recommend this venue for meetings and training

**Psychology4Learning**

I recently used the Training hub to deliver some training on behaviour management. I found the whole experience of using the Hub excellent.

The facilities are first class and I had access to wide range of resources to support the training day

**Jogo Behaviour Support**

# EMAT Training Hub

Host your next event at EMAT Training Hub and provide your attendees with an exceptional experience in a dynamic and inspiring setting.

Reserve your space today!

- Workshops
- Training
- Staff meetings
- Seminars and webinars
- Team-building sessions
- Presentations and conferences



**01604 215149**



**training@emat.uk**



**emat.uk**



Pyramus House  
Grange Park  
Northampton  
NN4 5EA

